

Standard Equipment /Optional Equipment

Standard Equipment

Fully suspended operator compartment	Automatic speed reduction when cornering
Narrow chassis width b1=770mm	Electromagnetic emergency brake acting proportionally to the load weight
Key switch or PIN Code access	CAN bus technology
Multifunction coloured display as well as hourmeter, maintenance indication, battery discharge indicator and internal fault code indication	Drive wheel Polyurethane
Power assisted steering	Single load wheel Polyurethane
ECO-Mode with up to 12% energy savings	Battery compartment for 3PzS and 4PzS
Drive wheel position mentioned in display (S)	Width over fork carriage: 580mm
Steering wheel left or right side (S)	Fork carriage length: 1150mm
	Protection -10°C

Optional Equipment

Drive wheels: cushion rubber, synthetic cushion rubber non marking, wet grip	<b>Linde Connected Solutions:</b>
Load wheels: tandem polyurethane, tandem polyurethane greasable	ac:access control (PIN or RFID Dual), an:usage analysis and dt:crash detection
Lateral battery change 3PzS and 4PzS with ergonomic battery un/locking with lever	Mast Protection: polycarbonate, mesh
Load backrests with h=800mm	Flashing beacon
Floor compensator	Support Clipboard DIN A4
Speed reduction if forks lowered	Support data terminal incl. power supply cable 24V
	Mobile or Fixed battery stand
	Automatic battery watering system
	Cold store protection -35°C

<b>Li-ION technology</b>
Rapid full charge
Opportunity charging
Rapid intermediate charging
Maintenance free
Extended lifetime
Efficient performance in Cold Stores
Side Plug available

<b>Li-ION batteries</b>
Fits in 3 PzS SL compartment: 4,5kWh-9kWh (205Ah-410Ah)
Includes battery housing extra weight
<b>Li-ION charger</b>
Optimized 24V-Charger v255: full charging time 1h30min (4,5kWh) and 2h40min (9,0kWh)

Other options available on request

Safety

High performance combined with safety. The operator’s body remains safely within the chassis contours at all times. A deadman foot switch ensures instant braking response when necessary. The truck comes rapidly to a smooth stop thanks to an electromagnetic brake which acts proportionally to the load on the forks. Due to its compact chassis, the fork tips are easily visible ensuring safe load handling.

Performance

One of the truck’s great strengths is its productivity. With capacity up to 2,000 kg, and a powerful maintenance-free 3 kW drive motor providing a maximum speed of 10 km/h, the Linde Stand-on Double Stacker is designed to load/unload and transfer two double-stacked pallets simultaneously, but can also be used as a normal stacker to store and retrieve loads in narrow aisles and for rapid pallet transfer applications.

Comfort

The fully suspended operator compartment, completely decoupled from the chassis keeps the driver concentrated and maintains high efficiency levels throughout the shift. Allied with a padded backrest, the operator’s stability is assured.

Stand-on Double Stacker  
Capacity 1200 kg  
D12 S, D12 SF

Series 1164



Features

- Fully suspended operator compartment**
- Standard on all truck versions (S and SF)
  - Decoupled stand-on platform and drive unit from the chassis (S and SF)
  - Comfortable and curved padded backrest (S)
  - Significant reduction of vibrations transmitted to the body
  - Ergonomic 90° driving position (S)



- Multiple driving positions**
- Side (S) version: vertical to forks direction
  - TipControl®, an innovative drive and lift control unit
  - Steering wheel on right or left side
  - Ergonomic driving position with comfortable backrest
  - Stand Front (SF) version: in forks direction
  - Twin grip handle bar

- Narrow chassis**
- Chassis width = 770mm
  - Small I2 dimension = 800mm
  - High maneuverability when operating in lorries or confined spaces
  - High stand-on position for good visibility
  - Stable 4 point configuration

- TipControl®**
- Traction, lift controls and horn grouped in one single ergonomic unit
  - Enables one-handed operations
  - High modularity: either left or right side
  - Height adjustable hand platform
  - Available on Side (S) version

- Drive control and settings**
- Steering effort adjusts automatically to speed and turning radius
  - Speed is automatically reduced in relation to the steering angle
  - ECO-Mode up to 12% energy savings to finish shift with low battery status



- Workstation**
- Multifunctional coloured display with easy & ergonomic menu structure
  - Truck access control by PIN code or ignition key
  - Wide and deep storage compartment for work gloves, writing utensils etc
  - Support clipboard DIN A4, flashing beacon available as option



- Comprehensive energy solutions**
- Battery tray for DIN batteries
  - 24V batteries: capacities from 345 Ah (3PzS) to 500 Ah (4PzS)
  - Lateral battery change with ergonomic battery lever & spring (option)
  - Li-ION batteries from 4,5kWh to 9kWh (205-410Ah/3PzS)
  - Rapid full charge in 1h30min with optimized charger



- AC motor**
- Powerful, 3 kW drive motor
  - Maintenance-free, moisture and dust proof AC motor
  - Gradient performance of max. 15% (laden)
  - No roll back on gradient starts
  - High torque motor negotiates loading docks with ease



Linde Material Handling GmbH, Postfach 10 01 36, 63701 Aschaffenburg, GermanyPhone +49.6021.99-0, Fax +49.6021.99-1570, www.linde-mh.com, info@linde-mh.com



Subject to modification in the interest of progress. Illustrations and technical details could include options and not binding for actual constructions. All dimensions subject to usual tolerances.

Printed in Germany 7/17.e. 2.0517.lndCki



Technical Data according to VDI 2198

Characteristics	1.1	Manufacturer		LINDE	LINDE
	1.2	Manufacturer's type designation		<b>D12S</b>	<b>D12SF</b>
	1.2a	Series		1164-00	
	1.3	Power unit		Battery	Battery
	1.4	Operation		Stand on	Stand on
	1.5	Load capacity/Load	Q (t)	1.2 / 1.8 <sup>1)</sup>	1.2 / 1.8 <sup>1)</sup>
	1.6	Load centre distance	c (mm)	600	600
	1.8	Axle centre to fork face	x (mm)	860 (745) <sup>2) 3)</sup>	860 (745) <sup>2) 3)</sup>
	1.9	Wheelbase	y (mm)	1780 (1665) <sup>2) 4) 3)</sup>	1780 (1665) <sup>2) 4) 3)</sup>
Weights	2.1	Service weight	(kg)	1348 <sup>5) 6)</sup>	1348 <sup>5) 6)</sup>
	2.2	Axle load with load, front/rear	(kg)	1224 / 1924 (1100 / 2048) <sup>5) 2) 7)</sup>	1224 / 1924 (1100 / 2048) <sup>5) 2) 7)</sup>
	2.3	Axle load without load, front/rear	(kg)	943 / 405 <sup>5) 6)</sup>	943 / 405 <sup>5) 6)</sup>
Wheels/Tyres	3.1	Tyres rubber, SE, pneumatic, polyurethane		V+P/P <sup>8) 9)</sup>	V+P/P <sup>8) 9)</sup>
	3.2	Tyre size, front		Ø 254 x 102	Ø 254 x 102
	3.3	Tyre size, rear		Ø 85 x 85 (2x Ø 85 x 60) <sup>10)</sup>	Ø 85 x 85 (2x Ø 85 x 60) <sup>10)</sup>
	3.4	Auxiliary wheels (dimensions)		2x Ø 140 x 50	2x Ø 140 x 50
	3.5	Wheels, number front/rear (x = driven)		1x + 2 / 2 (1x + 2 / 4) <sup>10)</sup>	1x + 2 / 2 (1x + 2 / 4) <sup>10)</sup>
	3.6	Track width, front	b10 (mm)	484 <sup>3)</sup>	484 <sup>3)</sup>
	3.7	Track width, rear	b11 (mm)	380 <sup>3)</sup>	380 <sup>3)</sup>
Dimensions	4.2	Height of mast, lowered	h1 (mm)	1315 <sup>3)</sup>	1315 <sup>3)</sup>
	4.3	Free lift	h2 (mm)	795 <sup>3)</sup>	795 <sup>3)</sup>
	4.4	Lift	h3 (mm)	1724 <sup>3)</sup>	1724 <sup>3)</sup>
	4.5	Height of mast, extended	h4 (mm)	2244 <sup>3)</sup>	2244 <sup>3)</sup>
	4.6	Initial lift	h5 (mm)	125	125
	4.15	Height, lowered	h13 (mm)	86	86
	4.19	Overall length	l1 (mm)	2170 <sup>4) 3)</sup>	2170 <sup>4) 3)</sup>
	4.20	Length to fork face	l2 (mm)	1020 <sup>4) 3)</sup>	1020 <sup>4) 3)</sup>
	4.21	Overall width	b1/b2 (mm)	770 <sup>3)</sup>	770 <sup>3)</sup>
	4.22	Fork dimensions DIN ISO 2331	s/e/l (mm)	55 x 180 x 1150 <sup>11)</sup>	55 x 180 x 1150 <sup>11)</sup>
	4.24	Width of fork carriage	b3 (mm)	710 <sup>3)</sup>	710 <sup>3)</sup>
	4.25	Fork spread	b5 (mm)	560 <sup>3)</sup>	560 <sup>3)</sup>
	4.26	Distance between wheel arms/loading surfaces	b4 (mm)	196	196
	4.32	Ground clearance, centre of wheelbase	m2 (mm)	20 <sup>12)</sup>	20 <sup>12)</sup>
	4.34.1	Aisle width for pallets 1000 x 1200 crossways	Ast (mm)	2766 (2802) <sup>4) 2) 13)</sup>	2766 (2802) <sup>4) 2) 13)</sup>
Performance	5.1	Travel speed, with/without load	(km/h)	10 / 10 <sup>14)</sup>	10 / 10 <sup>14)</sup>
	5.2	Lifting speed, with/without load	(m/s)	0.013 / 0.023 (0.064 / 0.089) <sup>2) 4)</sup>	0.013 / 0.023 (0.064 / 0.089) <sup>2) 4)</sup>
	5.3	Lowering speed, with/without load	(m/s)	0.045 / 0.032 (0.073 / 0.075) <sup>2) 4)</sup>	0.045 / 0.032 (0.073 / 0.075) <sup>2) 4)</sup>
Drive	5.8	Maximum climbing ability, with/without load	(%)	13.0 / 20.0	13.0 / 20.0
	5.10	Service brake		Electro-magnetic	Electro-magnetic
	6.1	Drive motor rating S2 60 min	(kW)	3	3
	6.2	Lift motor rating at S3 15%	(kW)	2.2	2.2
	6.3	Battery according to DIN 43531/35/36 A,B,C,no		43 535 / B	43 535 / B
	6.4	Battery voltage/rated capacity (5h)	(V)/(Ah)	24 / 345/375	24 / 345/375
	6.5	Battery weight (± 5%)	(kg)	287	287
	6.6	Power consumption according to VDI cycle	(kWh/h)	1.01	1.01
	8.1	Type of drive unit		LAC	LAC
	10.7	Sound pressure level LpAZ (at the driver's seat)	(dB(A))	67 <sup>15)</sup>	67 <sup>15)</sup>

1) Load distribution e.g. 800 kg on the forks, 1000 kg on the fork arms. Total load max. 1800 kg.  
2) Figures in parenthesis with initial lift  
3) (± 5 mm)  
4) ± 0 mm = 3 PzS lateral;<br><br>+ 100 mm = 3 PzS vertical and 4PzS lateral;<br><br>+ 150 mm = 4 PzS vertical;<br><br>+ 225 mm = 5 PzS vertical  
5) Figures with battery, see line 6.4/6.5.  
6) (± 10%)  
7) Load: 2000 kg  
8) Drive Wheel Option: rubber non marking, Polyurethane and wet grip  
9) Solid rubber / polyurethane / polyurethane  
10) Figures in parenthesis with tandem load wheels.  
11) Reach legs 75x150x1115  
12) (± 2 mm)  
13) Including a 200 mm (min.) operating aisle clearance.  
14) (± 5%)  
15) (± 2.5)

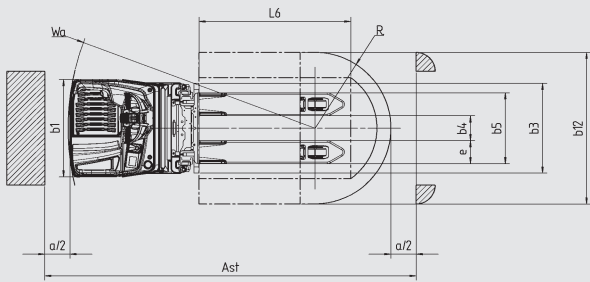
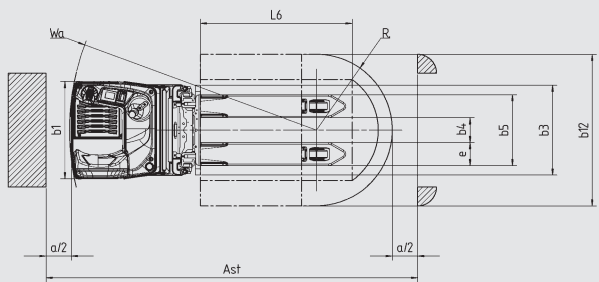
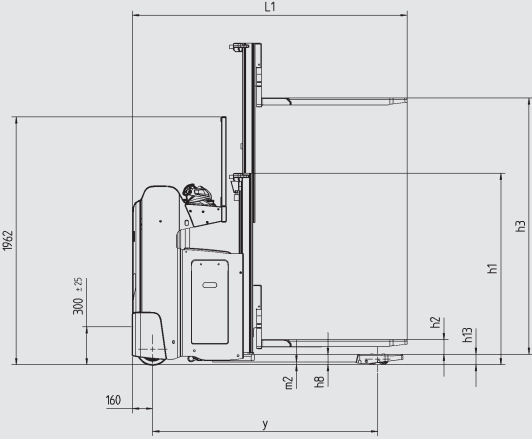
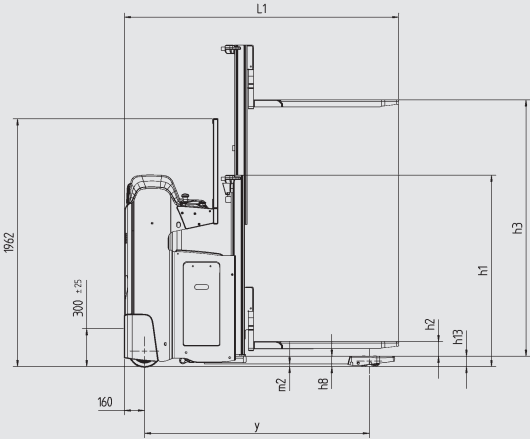
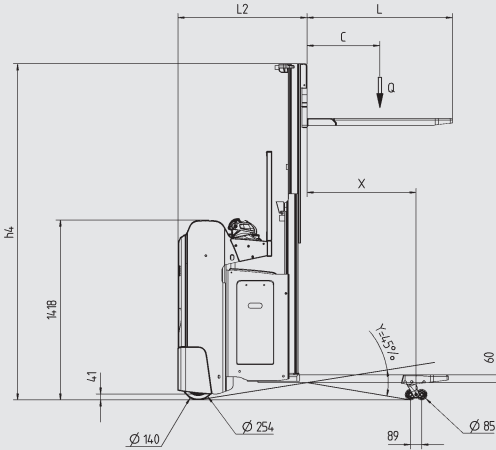
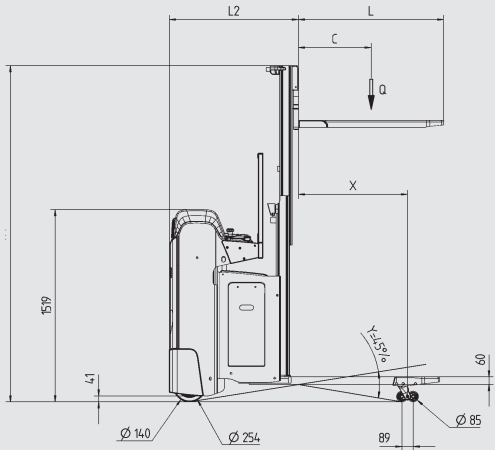

Masts (D12 S / D12 SF) (in mm)		1574 S	1724 S	1924 S	2024 S	2124 S	1574 D	1724 D	1924 D	2024 D	2124 D
Lift	<b>h3</b>	1574	1724	1924	2024	2124	1574	1724	1924	2024	2124
Lift + fork height	<b>h3+h13</b>	1660	1810	2010	2110	2210	1660	1810	2010	2110	2210
Height, mast lowered	<b>h1</b>	1315	1390	1490	1540	1590	1315	1390	1490	1540	1590
Height, mast extended	<b>h4</b>	2094	2244	2444	2544	2644	2094	2244	2444	2544	2644
Free lift	<b>h2</b>	150	150	150	150	150	720	795	895	945	995

